



**2018**

**ARCHAEOLOGICAL WATCHING BRIEF  
AT  
STRAWBERRY FIELDS, 7 PENNY LANE  
COWBRIDGE, VALE OF GLAMORGAN**



**Cardiff Archaeological Consultants**  
Project 2018-001  
Report 2018-05

**Jean-Yves Robic, MCIfA**  
May 2018

**ARCHAEOLOGICAL WATCHING BRIEF  
AT  
STRAWBERRY FIELDS, 7 PENNY LANE  
COWBRIDGE, VALE OF GLAMORGAN**

**Planning Permission:  
2017/01313/FUL, Condition 3**

**Project 2018-001**

**Report 2018-05**

**Prepared by J.-Y. Robic, MCIfA**

**for**

**S. Andrews & Son (Pwellhi) Ltd**

**Agent:  
Nick Renwick, Architect**

**May 2018**

## **CONTENTS**

1. *Summary*
2. *Site location and description*
3. *Summary of archaeological potential*
4. *Aims and objectives of the investigation*
5. *Methodology*
6. *The watching brief results*
7. *The finds*
8. *Conclusions*
9. *Acknowledgements*
10. *References*
11. *Appendices*
- 11.1 *Summary list of contexts*

## **ILLUSTRATIONS**

### **Figures**

Figure 1: Location maps

Figure 2: Location plan

Figure 3: Existing site plan and location of the watching brief area

Figure 4: Cowbridge, plan of the town defences (Spurgeon 2001, 180)

Figure 5: The medieval burgage plots (Robinson 1980, Fig. 10)

Figure 6: The proposed development area between 1841 and 1919

Figure 7: Plan of the excavated area

Figure 8: Sections

### **Plates**

Front cover: The proposed development from the south

Plate 1: The watching brief area from the south-west

Plate 2: Typical section from the south

Plate 3: The building 14 from the south

Plate 4: The building 14 from the west

## **Copyright**

Cardiff Archaeological Consultants retain the copyright of this document under the *Copyright, Designs and Patents Act 1988*, and have granted a license to **S. Andrews & Son (Pwellhi) Ltd and their agents** to use and reproduce the material contained within. Plans reproduced by permission of Ordnance Survey® on behalf of The Controller of Her Majesty's Office. © Crown copyright. All rights reserved. License number 100057058

The opinions expressed here are of a personal nature and alternative views may have equal validity; no responsibility can be accepted, however, for any omissions of fact or opinion, however caused.

## **Cardiff Archaeological Consultants, Cardiff Archaeological Consultants**

33 Nicholl Court, Boverton, Llantwit Major CF61 2LR , tel 01446 795552,  
[cardiff.consultants@gmail.com](mailto:cardiff.consultants@gmail.com) LR

12 Seymour Road, Bristol BS7 9HR, tel.0117-9858 109, [m.ponsford@ipresent.co.uk](mailto:m.ponsford@ipresent.co.uk)

## **1. Summary**

*An archaeological watching brief was conducted on an ad hoc basis in April 2018 in accordance with a written specification at Strawberry Fields, 7 Penny Lane, Cowbridge, Vale of Glamorgan. A small section of a building, probably dated to the 19th century, was recorded in the eastern foundation trench. The watching brief confirms that potential medieval or earlier archaeological resource may be preserved in situ within the watching brief areas.*

## **2. Site location and description**

**2.1** The site which forms the subject of this specification is located at Strawberry Fields, 7 Penny Lane, Cowbridge, Vale of Glamorgan (NGR SS 99628 74614; Figures 1 and 2). The development area covers some 30 square metres (Figures 2 and 3, Plates 1 and 2) and lies at an altitude of around 26 m AOD. The site is bordered to the west by the diverted River Thaw, to the south by High Street and to the east by the walls of the house and garden at 9 High Street. The north side of the development area is formed by the continuation, northward, of the row of shops forming the retail precincts. The proposed development area previously formed an outdoor display area for the former greengrocer shop that occupied 7 Penny Lane.

**2.2** Cardiff Archaeological Consultants was commissioned to carry out an archaeological watching brief for S. Andrews & Son (Pwellhi) Ltd following the granting of Planning Permission 2017/01313/FUL by the Vale of Glamorgan Council for the extension to the existing shop and associated works at 7 Penny lane, Cowbridge, Vale of Glamorgan.

**2.3** The specification and watching brief were requested in condition 4 of the Planning Permission. The condition reads:

*“No development shall take place until the applicant, or their agents or successors in title, has secured agreement for a written scheme of historic environment mitigation which has been submitted by the applicant and approved by the local planning authority. Thereafter, the programme of work will be fully carried out in accordance with the requirements and standards of the written scheme.*

*Reason: To identify and record any features of archaeological interest discovered during the works, in order to mitigate the impact of the works on the archaeological resource, and to ensure compliance with the terms of Policy MD8 of the Local Development Plan.”*

**2.4** An ordered archive will be deposited with the Cowbridge Museum, Cowbridge.

### **3. Summary of archaeological potential**

#### **3.1 General**

The town of Cowbridge is located centrally in the Vale of Glamorgan, in the valley of the Thaw River, at a point on the river which facilitates a crossing point. The site of the town is surrounded by low hills and is therefore sheltered, the agricultural quality of the land being relatively rich. These attributes place Cowbridge in a favourable position for settlement and exploitation.

There is very little evidence for prehistoric activity within the Vale of Glamorgan until the Neolithic and Bronze Age, when evidence from the area is predominantly in the form of burials. The Neolithic evidence within the Cowbridge vicinity is not great, although some examples of chambered tombs of a type known as Cotswold Severn, from the extent or their distribution, exist in the Vale. Bronze Age evidence is rather more widespread – again mainly funerary remains in the form of cairns – although the nature of the finds (such as a knife, palstaves and axe heads) known from the Cowbridge area suggests settlements existed at that time (Robinson 1980).

During the Iron Age, the nature of the archaeological remains, in contrast to the earlier periods, consist of settlement or ritual deposits. In the upland area of Glamorgan, small hut circles and enclosures tend to be the common settlement type, although in the lower-lying Vale larger hillforts and enclosures are predominant. The hillfort of *Caer Dynnaf* lies to the west of Cowbridge and encloses an area of c 3.8ha, while *Llanquian Wood* to the east encloses 2.2ha. These may indicate an ordered society at the time when the tribal group known as the Silures occupied the lowland area of South Wales and opposed the Roman occupation.

The Roman invasion of South Wales, which commenced in the late 40s AD, gathered momentum in the 70s with the establishment of the road system across South Wales and the legionary fortress at *Caerleon (Isca)*, manned by the *Legio II Augusta*. The road system linked a series of forts, which in Glamorgan comprised Cardiff, Gelligaer, Penydarren, Neath, Loughor and Coelbren. It has been suggested that Cowbridge is the location of the fort known as *Bovium*, mentioned in *Iter XII* of the Antonine Itinerary. The main road running through the centre of the town of Cowbridge is the Roman road linking the Roman fortress of *Caerleon* with *Carmarthen*. Major excavations in Cowbridge over the last twenty years have revealed considerable evidence of Roman occupation. The remains of structures, including a bath-house to the north of the main road, which appears to be of military design, have been recorded (Parkhouse and Evans 1996). Although heavily disturbed by the construction and expansion of the medieval town, Romano-British remains have also been located along the High Street and Westgate. Finds include a bronze fibula found on the other side of the Broad Shoard.

During a watching brief at 34 and 35 Westgate a number of Romano-British features were uncovered, expanding the area of Roman discoveries to the south of High Street (Cardiff Archaeological Consultants, forthcoming).

In the Vale of Glamorgan, the fertile lower-lying land was certainly being exploited as a number of farmsteads and villas were established – Llantwit Major, Moulton and Whitton are all within 10km of Cowbridge, while the farmstead at Llanfrynach is less than 2km from Cowbridge. The Roman occupation of this area lasted until the 5th century AD, although any continuity of settlement or ordered society is tenuous until the medieval period.

Following the Norman invasion, the Cowbridge area became part of the Lordship of Glamorgan during the latter part of the 11th century. Robert Fitzhamon established a capital at Cardiff and the lordship extended from the River Rhymney initially to the Ogmere River, then to the River Tawe, and north covering the lowland vale. Boroughs, defended towns, markets, churches, fairs and castles were all founded during a period of rapid urban growth. Towns were created and laid out with plots known as burgages, held by burgesses who paid rent to the lord, thereby becoming a great source of wealth for the ruling class.

During the medieval period, when the area came under the control of Richard de Clare, Cowbridge's earliest phase was planned and laid out in burgage plots with originally about 59 burgages spread along both sides of the Roman road. The burgages were long narrow rectangular plots of land with the narrow end at the street frontage and the plot extending away from the road. Normally buildings were located on the street frontage with gardens or working areas behind. Llanblethian Castle, to the south-west of Cowbridge, provided the focus of defence for the area, as there was no castle in Cowbridge itself. This appears to have been a deliberate choice and the town was probably planned as a purely commercial venture (Soulsby 1983). The church of the Holy Cross was originally the chapel of ease to the parish church, which was at Llanblethian. It is unlikely that the church predated the town's first charter in 1254 (Evans 1998). The walls around the town enclose an area of approximately 30 acres, and although there is no documentary evidence for their construction, they are likely to have been in existence before the 13th century. The town expanded rapidly in planned units to the east and west of the walled zone and during the latter part of the 13th century the number of burgages in Cowbridge is estimated as being 230.

### **3.2 Roman and Later Cowbridge**

In the monograph *Excavations in Cowbridge, South Glamorgan, 1977-88* (Parkhouse and Evans 1996) a detailed synthesis is given of the archaeological works carried out on the Roman, medieval and post-medieval sites in Cowbridge.

#### **3.2.1 Roman Cowbridge**

The Roman settlement of Cowbridge is located on the Roman road between Cardiff and Neath and seems to have been developed in the vicinity of the road, although many of the excavated features were not aligned on the road (Parkhouse and Evans in Parkhouse and Evans 1996, 233).

A clear picture of Cowbridge during the Roman period is still difficult to draw with precision. Several elements (catapult bolt, helmet piece and the bath-house) found in some of the

sites excavated seem to indicate a military origin or at least an official one (Parkhouse and Evans in Parkhouse and Evans 1996, 234).

Most of the recent excavations were conducted north of North Road, beyond the wall of the medieval town and in Hopyard Meadow at the western extremity of the town.

### Bear Field

Excavations carried out between 1979 and 1984 revealed a series of drainage gullies and ditches probably associated with light buildings. The finds suggest an occupation starting in the 2nd century AD and finishing in the second half of the 3rd century AD. A series of ten flues were also excavated. Dating evidence shows that they were out of use by the middle of the 4th century AD (Evans in Parkhouse and Evans 1996, 4-40).

### Bear Barn

A similar series of gullies, pits, postholes and stakeholes to those found in Bear Field was excavated in 1981 (Parkhouse in Parkhouse and Evans 1996, 41-44).

### Arthur John Car Park

Nine hundred square metres were excavated in 1981 and revealed a Roman bath building dated to the early 2nd century AD. The building was composed of a linear unit of five rooms (Reinhentyp plan) together with three side rooms. A *praefurnium* and ancillary room were later added then replaced in turn by a large *praefurnium*. Two T-shaped kilns were found north of the bath building. Four burials were also found on this site. These later features seem to indicate some continuity during Roman times. (Parkhouse in Parkhouse and Evans 1996, 45-72).

### 83 High Street (Woodstock House)

Part of a building dated to the 3rd century AD constructed on rubble-filled foundation trenches was uncovered and excavated (Parkhouse in Parkhouse and Evans 1996, 73).

### 77 High Street

A number of linear gullies and undiagnostic pits dating from the 2nd and 3rd centuries AD were excavated (Parkhouse in Parkhouse and Evans 1996, 74-79).

### 75 High Street

A late 1st-century AD Roman road ditch and a rubbish pit with two associated buildings were discovered during the 1977 excavation of the 'Old Brewery'. One of the buildings was founded on sleeper beams and the other on stone wall footings. After destruction of the two buildings around 160 AD, a minor road setting off from the main thoroughfare occupies the land until the second half of the 4th century AD. The road ditch is the earliest known Roman feature in Cowbridge (Allen and Parkhouse in Parkhouse and Evans 1996, 80-90).

### 61 High Street (Midland Bank)

Excavations conducted during 1981/82 revealed a large Romano–British ditch with a width in excess of 5 metres and depth in excess of 1 metre. Dating evidence suggest that it was filled quite rapidly, after being open for some time, during the latter half of the 2nd century AD (Parkhouse in Parkhouse and Evans 1996, 91-102).

### Hopyard Meadow

Two Romano-British ditches, a series of postholes and the eroded remains of a wall footing were excavated on this large plot at the west end of the town. Among the large quantity of Roman pottery recovered from the fill of the ditches, a sandstone lion sculpture is the most remarkable find. The evidence of the finds indicates a date around the middle of the 4th century AD for the backfilling of the ditches but the lion sculpture could indicate the presence of a nearby cemetery during the 2nd century AD (Marvell in Parkhouse and Evans 1996, 110-124).

### Shortland, Westgate

Three silver *Urbs Roma* coins (c 330-335) and other Romano-British finds were found (Parkhouse in Parkhouse and Evans 1996, 124).

### Westgate

A layer of Roman deposit was found during the digging of a service pit. A fibula found at the turn of the century is probably from the same site (Parkhouse in Parkhouse and Evans 1996, pp.124).

### Old Hall, High Street

A metre of Roman deposit was observed in the early 1970s (Parkhouse in Parkhouse and Evans 1996, 124).

### 73 High Street

The cutting of a cable trench permitted the recording of a layer of Roman deposit at a depth of one metre below the existing ground. This layer was followed from the edge of the High Street to the northern wall of the town (Parkhouse in Parkhouse and Evans 1996, 124).

### 57 High Street:

A number of foundation trenches were examined and revealed a layer of Roman deposit containing building debris (ceramic and sandstone roof tile) overlain by another layer of Roman deposit (Parkhouse in Parkhouse and Evans 1996, 125).

### **3.2.2 Medieval and post-medieval Cowbridge**

After a hiatus of nine centuries following the end of the Roman settlement, the town developed rapidly after it had received its first charter in 1254 from Sir Richard de Clare who founded the borough in the 1240s after he took possession of the lordship of Tal-y-Fan and the manor of Llanblethian (James and Francis 1979, 24, 32). The market town grew rapidly inside its stone wall and the 59 burgesses in residence in 1262-3 rose to 233 in 1295. Around 1300 Cowbridge was one of the largest and most flourishing towns in Wales, only superseded by Cardiff (James and Francis 1979, 33). Cowbridge continued to enjoy a lesser degree of prosperity in the later 15th century and until the early 20th century relied on the basic business and wealth generated by the trade of livestock and produce of the markets and fairs (ibid, 47-48).

The area of the medieval town affected by the different archaeological operations is small. Part of thirteen burgage plots were excavated but interpretation of the results was difficult as the size of the areas studied was restricted (Parkhouse and Evans 1996,).

#### Bear Barn

A group of agricultural buildings and stable probably originated during the 18th century with the construction of a barn. Other buildings were subsequently added (Parkhouse in Parkhouse and Evans 1996, 44).

#### 83 High Street (Woodstock House)

Several post-medieval pits were uncovered under the modern superficial layers. On the western edge of the site the remains of the medieval town wall were excavated. A short length of a medieval gully was also studied (Parkhouse in Parkhouse and Evans 1996, 73-74).

#### 77 High Street

The corner of a medieval limestone and clay wall was found in the south-eastern corner of the excavation. A small post-medieval cobbled courtyard overlay the medieval features (Parkhouse in Parkhouse and Evans 1996, 76-79).

#### 75 High Street

A 14th-century rectangular building (16.7m x 7.6m) with some evidence of internal arrangements was excavated. The building was then modified and altered during the 18th century. A well of drystone construction dating from the medieval and post-medieval periods was found in the north-east corner of the site (Parkhouse in Parkhouse and Evans 1996, 88-89).

### 61 High Street (Midland Bank)

A large 13th-century waterlogged pit was excavated. The main feature was a section 3.6m long of the medieval defences with its associated ditch. The wall was 1.8m thick and survived to a height of 2.3m. An abutment for a bridge spanning the ditch outside the north gate was also identified. The remains of a large medieval building with internal wall and clay floor constructed parallel with and adjacent to the road leading from the High Street to the north gate were excavated (Parkhouse in Parkhouse and Evans 1996, 93-109).

### Hopyard Meadow

One of the rare medieval sites excavated outside the perimeter of the town wall, it revealed a large ditch and two contemporary buildings and two rubble-filled pits. The site was later occupied during the post-medieval period (boundary bank and gullies) and subsequently occupied in the west end of the eastern property by a building with associated latrine, a possible 'nailer's shop and garden', still standing in the early 20th century (Marvell in Parkhouse and Evans 1996, 114-123).

### 45 and 47 High Street (Verity's Court)

Thirteenth- or 14th-century pottery was discovered on the line of the town defences. The line of the inner edge of the town ditch was also recorded (Parkhouse in Parkhouse and Evans 1996, 125).

### 41 High Street

Vestiges of the town wall were observed 'fossilised' in one of the property boundaries (Parkhouse in Parkhouse and Evans 1996, 125).

### 27 High Street

The foundation wall of the northern end of a medieval building was excavated (Parkhouse in Parkhouse and Evans 1996, 125).

### 63 High Street (The Bear Hotel)

Believed to be the oldest medieval building in the town, the Bear Hotel was formerly a town house. The Bear Hotel was probably a three-unit, lateral chimney, hall-house of the late medieval period, later converted into a storeyed house. To the north of the house, and linked with it by a later addition, is a formerly detached structure probably of medieval date (RCAHMW 1982, 144-145). A limited excavation in 1979 at the rear of the hotel revealed a cross-section of the medieval town wall. Beneath the foundation of the wall a layer of Romano-British date was uncovered (Parkhouse in Parkhouse and Evans 1996, pp.124-125). The building was converted to an inn during the 16th century and in the late 17th century was a posting house run by the Bradleys, a renowned South Wales coaching family

(Leijerstam 1992, 41). The 1979 excavation also revealed the presence of a mid-19th-century building and cobbled floor, probably a stable block for the posting house. Other similar 19th-century structures were observed during excavations on the site of the Bear Hotel car park north of North Road at the rear of the hotel (Parkhouse in Parkhouse and Evans 1996, 124-125).

### Back of the Institute (Behind Town Hall)

The removal of the topsoil at the back of the Institute (now demolished) revealed the lower course of the north section of the town wall. The masonry was reported to have been 8ft (2.13m) wide and yellow clay bonded. The external side of the wall presented a considerable batter and was faced with dressed stone (Evans 1914, 304)

### **3.3 The Town Walls**

If the date of the foundation of the town is no longer doubtful, the history and development of the Cowbridge town walls remain unclear. C.J. Spurgeon in 2001 reviewed the question and suggested that the walls were built when the borough was founded in 1254 (Spurgeon 2001, 179). Using Robinson's (Robinson 1982) estimation of the number of burgage plots inside the walled area and their rate of growth, Spurgeon deduced that extra-mural settlement may have been necessary as early as 1269 (Spurgeon 2001, 179). The construction of the walls should then be attributed to Richard de Clare rather than Gilbert II. The town walls enclosed a pentagonal area of 5.50 hectares (Robinson 1980, 45) with its course reasonably well established (Figure 3). The wall was fronted by a ditch 8m wide (Soulsby 1983, 115) probably holding water (Spurgeon 2001, 183). Excavation on the site of the Midland Bank (see above 61 High Street) revealed part of the ditch of which the last section was filled after 1853 (Soulsby 1983, 115). Four gates gave access to the town of which only the south still stands. The north gate may have been already ruined by the end of the first half of the 16th century (Spurgeon 2001, 183). The two main gates in the east and west remained the principal entry points of the main road in the town until the mid-18th century (Robinson 1980, 47). The west gate was demolished in 1754 and the east gate survived only a few more years until it was removed between 1768 and 1775 (Robinson 1980, 47).

If the plan of the town walls seems to be now well established, its original dimensions have been extrapolated from the rare sections excavated and from the surviving south-west section. In 1999 Marches Archaeology (Marches Archaeology 1999) surveyed the standing sections of the town walls and reviewed the published evidences. The preserved sections of the wall were between 2.30m (Midland Bank) and 3.6m (West wall) high and the width between 1.80m (Midland Bank) and 2.13m (Back of Institute). Apart from the south gate, the report also identified several sections of the surviving wall as original or rebuilt on the medieval foundations:

#### West of south gate

First 30m were completely rebuilt, next 18m were rebuilt on the medieval foundation and the next 22m are original (3.60m high x 1.80m wide with external batter), the next 12m

were rebuilt on medieval foundations and the remaining 27.5m leading to the south-west tower is original. The lower battered section of the tower is also deemed original while the upper part incorporated the walls of an 18th-century summerhouse (Marches Archaeology 1999).

#### North of the south-west tower

Forty metres is mostly original with a terrace built against its internal side and added crenellations. The next 30m were completely rebuilt and a 15m-section is integrated into the fabric of the former Masons Arms (now a restaurant), itself a medieval building (Marches Archaeology 1999).

The results of the non-intrusive survey of the walls by Marches Archaeology was incorporated in Spurgeon's description of the Cowbridge walls (Spurgeon 2001, 186-187) and constituted the latest published appraisal of the structure.

Since the publication of Spurgeon's paper on the medieval town defences in Glamorgan, Cardiff Archaeological Consultants have conducted a series of excavations on the south section of the wall located between the south-west tower and the south-east tower.

#### The former Grammar School

The first excavations were carried out in 2006 in the garden of the former Grammar School and in the Boot House, a post-medieval building abutting the south gate (report forthcoming). The excavations below the floor of the boot house revealed that the foundation of the medieval wall extended 1.30m inward. The fabric of the wall was similar to the one described in the excavation of the north section of wall, i.e. dressed limestone blocks with clay bonding. To the east of the Boot House the medieval wall had been demolished and all the stone removed. Its line was marked only by the dark fill of the robber trench leading to the south-east bastion on the same course as the modern boundary wall. Artefacts recovered from the trench suggest a date for its infilling of the second half of the 18th century.

#### Health Centre Grounds

In 2007, another opportunity was provided for Cardiff Archaeological Consultants to investigate the south section of the wall from the west wall of the newly renovated Physic garden to the south-west tower in the grounds of the Health Centre (Cardiff Archaeological Consultants 2007). Four areas, T1, TP1, TP2, and TP3 were evaluated. The first one in front of the 19th-century boundary wall immediately west of the Physic Garden showed that the foundation of the medieval wall was of similar fabric to that uncovered in the former Grammar School Boot House. The stepped foundations projected 1.80m to the north and were built against a clay bank. The width remains constant until it meets the upstanding section of the wall deemed to be original.

The next evaluation area to the west, TP1, was cut at the base of the section of the wall identified as original in the 1999 survey (Marches Archaeology 1999). The excavations

revealed that the base of the existing wall rested on a possible construction layer and that it overlaps the foundation of the medieval wall uncovered in T1.

TP2 was excavated further along the same section of the wall and clearly showed that the upstanding wall had been built on the remains of the medieval wall. The lower course of the wall is not tied in and a gap between the two walls is clearly visible. The stones of the modern wall are bonded with beige to light brown lime mortar in contrast to the clay-bonded medieval stonework. The difference in the quality of the stonework is also evident. A halfpenny of George III (1760-1820), probably issued in 1775, found in the construction layer 1 could indicate that the construction of the upstanding wall took place in the late 18th century. A residual rim sherd of a Roman amphora type Dressel 20 was discovered in the same context.

The results of the excavations of TP3 confirmed and completed the information from the two previous test pits. The same stratigraphical sequence was observed and the overlap of the two walls is even more evident. The fabric of the foundation of the medieval wall 03 is also similar to the one in test pit 2 and its base lies at a height of 28.14m OD. The position of the medieval wall, 0.50m to the north of the line of the later upstanding wall also clearly demonstrates that the line of the latter diverges from that of the original medieval wall. This also explains why the foundations of the medieval wall do not show below the wall 02, as they are obscured due to the diverging line of that wall.

The results of the 2006 and 2007 excavations clearly demonstrate the limitations of the 1999 non-intrusive survey of the south section of the town walls. The sections of the wall thought to be the original medieval wall have probably been partly rebuilt on the medieval foundations but following a different line, as shown by the overlap of the two structures in TP1 to 3. Doubt is also cast on the medieval attribution of the last section of upstanding wall leading to the south-west tower.

### **3.4 The development area**

Specific archaeological or historical information regarding the site of the new development is limited. The development site lies at the south end of a plot fronting the northern side of High Street and is thought to be following the line of the Roman road linking the fortress of Caerleon to Carmarthen. The site is also located 250m to the south-east of the Roman site at Arthur John Cark Park, excavated in 1980 and 1981. The excavations uncovered a Roman bath building dated to the early 2nd century AD and two T-shaped kilns were found north of the bath building. Four burials were also found on this site. These later features seem to indicate some continuity during Roman times (Parkhouse in Parkhouse and Evans 1996, 45-72).

Archaeological works by Cardiff Archaeological Consultants at 27 High Street in 2016 and 2017 showed that the archaeological resource was preserved below the modern floor and that the site was occupied from the Roman period to the 20th century. Residual Roman pottery and Clay Building Material (Bricks and tiles) showed that the site was occupied during the 2nd century AD but no Roman structural features were recorded. Below a post medieval occupation layer (Context 16), a probable central hearth and bake oven remains

suggested an early medieval occupation of the site. Two large cut features were dated to the medieval period but their function not ascertained. Later stone drains and modern ceramic drain pipes were also uncovered in the front room and in the side eastern passage (Cardiff Archaeological Consultants 2017).

Immediately to the south of the proposed development area, Roman pottery dated to the 1st and 2nd century AD were found during cable laying works at 2 High Street in 1962 (Parkhouse in Parkhouse and Evans 1996, 127).

Penny Lane is located outside the enclosed circuit of the medieval town walls but is only 50m east of the Eastgate (Figure 4) and probably occupies one or two of the late 13th-century burgage plots of the medieval town that extended to the east of the Eastgate (Figure 5).

The historical cartographic sources showed that the proposed development site was already occupied at the time of the 1841 town plan (Figure 6, A) and could date to the Medieval or Post-medieval period. The 1841 plan shows, on Plot 68, a rectangular building fronting the High Street with three smaller outbuildings depicted at the rear. The Plot is bordered on its western side by a drainage ditch that ran to the River Thaw which flowed further to the east at that time. The Tithe apportionments revealed that it was occupied by Elizabeth Williams (Edmund Williams, landowner) and was designated as a 'House and Garden'. The general shape of the plot seems to have retained the medieval burgage plots layout. By the time of the 1st edition Ordnance Survey map of 1877, the irregular frontage has been straightened and the facade set back from the street. The rear outbuildings have been replaced by two large rear extensions to the building. Garden paths are visible and an orchard is also suggested at the northern end of the plot (Figure 6, B). The 2nd edition Ordnance Survey maps shows that the original building fronting High Street has been demolished and two rectangular buildings, orientated north-south erected in the centre of the plot. The layout remains unchanged until 1919 when a sub-division of the eastern building is now marked on the map and a narrow rectangular building with northern extension has been built alongside the south-western plot boundary (Figure 6, C).

The Cowbridge Record Society has compiled a chronological list of owners and occupiers of Penny Lane since the late 18th century (Cowbridge Record Society 1999, 14). Thomas Morgan, a farmer from Llantrithyd was the owner in 1784. Ownership passed to his nephew Jenkins Morris, a maltster, in 1823 and subsequently, to his nephew, David Williams. Elizabeth Williams is recorded as an occupier in 1843 and 1851. She is succeeded in 1861 and 1871 by a stonemason called Mathias James. A builder's and monumental mason's workshops were established by John Hopkins and Sons in the early 1880s. In 1891 John Hopkins and Sons is listed in the Kelly's South Wales Directory as stonemasons at the Bridge, Cowbridge (Kelly 1891). Penny Lane remained a mason's yard until the 1970s when the actual shopping precincts was built; John Yeoman, greengrocer, has occupied number 7 Penny Lane since that time (Cowbridge Record Society 2003, 14).

Elizabeth Williams was living in the building depicted on the 1841 plan and the changes to the southern elevation visible on the 1877 map could be attributed to Mathias James. The demolition of the building fronting the street and its replacement by buildings in the centre

of the plot correspond with the installation of the Hopkins and Sons workshops in the early 1880s.

#### **4. Aims and objectives of the investigation**

**4.1** The proposals involve the construction of a single storey front extension and associated works (Figure 3).

**4.2** The groundworks for the foundations of the new extension and associated works could have a deleterious effect on potential buried archaeological resource.

**4.3** The excavation and recording will examine and record the archaeological resource within the specified area using appropriate methods and practices. These will satisfy the stated aims of the project and comply with the *Code of conduct, Code of approved practice for the regulation for contractual arrangements in field archaeology* and other relevant by-laws of the Chartered Institute for Archaeologists. It will result in appropriate published accounts and an ordered, accessible archive.

**4.4** The excavation and its record will provide sufficient information by which to determine the level of importance of surviving archaeological features and place them in an interpretative framework.

**4.5** To recover artefactual, environmental and technological evidence from the excavated deposits to provide cultural and chronological data towards an interpretation of the evaluated site.

#### **5. Methodology**

**5.1** The watching brief was carried out in the proposed development footprints during the mechanical excavation of the foundation trenches for the new extension (Figure 7). The work was conducted by trained archaeological professionals to the standards set by the Chartered Institute for Archaeologists (2014).

**5.2** The watching brief was carried out following the *Standard and Guidance for an Archaeological Watching Brief* adopted by the Chartered Institute for Archaeologists (2014) and *Management of Research Projects in the Historic Environment: The MoRPHE Project Managers' Guide* (Historic England 2015) in accordance with an approved Written Scheme of Investigation (Cardiff Archaeological Consultants 2016).

**5.3** Written, drawn and photographic records to an appropriate level of detail were made including context sheets, a site diary, three-dimensional field drawings and survey data. Plans and section drawings were at a scale of 1:20. The drawings were cross-referenced to fixed boundaries on the relevant OS plan.

## **6 The watching brief results**

**6.1** The watching brief was carried out by Jean-Yves on 19th April 2018 under generally dry and sunny weather conditions.

**6.2** The concrete paving tiles (Context 01) and sub-base (Context 02) were removed and a 'U' shaped trench was mechanically excavated in front of the retail unit (Figures 7 and 8). The trench was 0.80m wide and excavated to a depth of 1.10m below existing ground level. Several layers of concrete (Contexts 03 and 04, Plates 1 and 2) and the foundation trench (Context 05) for the concrete footings of the retail unit (Context 06) were exposed in the eastern and western trenches. The foundation trench 05 was filled with aggregates (Context 07). The foundation of the retail unit had cut through several probably 20th century made up ground layers (Context 07, 11 and 12). In the eastern trench, a thin band of buff lime mortar (Context 13) was interpreted as the bedding layer for a floor surface removed before the deposition of the 20th century made up ground and probably the construction of the existing retail unit. Below deposit 13, a thick layer of black soil (Context 09) containing 19th to early 20th century domestic artefacts was exposed to the base of the eastern trench and above a layer of subsoil (Context 10) in trench west.

At the base of the eastern trench, the remains of a narrow stone built rectangular structure (Context 14) were uncovered. The structure was 0.80m wide internally and built with faced limestone blocks bounded with white lime mortar (Plates 3 and 4). The structure continued to the west within Context 09 but was not exposed further than the width of the trench.

## **7 The finds**

Context 09 produces a small assemblage of the usual late 19th- to 20th-century finds with fragments of Blue and White Transfer-Printed pottery, white porcelain, brown lead glazed coarse ware, clay pipe stems, ceramic roof tiles and animal bones. None were retained.

## **8 Conclusions**

**8.1** The watching brief results are limited due to the restricted area of the excavation. The layers of made up ground exposed below the modern concrete paving were probably associated with the construction of the existing retail unit. The black soil 09 could be buried topsoil sealed by the lime mortar floor bedding layer 13 and probably of 19th to early 20th century date. The remains of the small rectangular construction may have been associated with some of the building fronting High Street and depicted on the late 19th and early 20th century maps historical map (Figure 6).

**8.2** The watching brief confirms that potential medieval or earlier archaeological resource, if it exists, may be preserved in situ within the watching brief areas.

## **9 Acknowledgements**

The author is pleased to acknowledge the help of Mr Nick Renwick, Architect in providing information and plans, of Chris Powell of Powell Builders and his staff during the watching brief and of Judith Smith, for editing this document.

## **10 References**

Cardiff Archaeological Consultants 2007. *An archaeological evaluation of the Town Walls, Health Centre Grounds, Cowbridge*. Report for the Cowbridge Charter Trust, Town Walls sub-committee deposited with HER, Swansea.

Cardiff Archaeological Consultants 2017. Archaeological watching brief at 27 High Street, Cowbridge, Vale of Glamorgan. Report 2017-18 for Simon Parton and Nicola David deposited with HER, Swansea.

County Treasures 2007: *Vale of Glamorgan, Cowbridge with Llanblethian*. Vale of Glamorgan Council, Barry.

Cowbridge Record Society 1999. *Cowbridge buildings & people*. Cowbridge

Evans, E., 1998. *Glamorgan Historic Churches Survey, Churches in the Archdeaconry of Llandaff, Deanery of Llantwit Major and Cowbridge, Cadw*

Evans, E., 1999. 'Cowbridge , 18 High Street'. *Archaeology in Wales* **39**, 130.

Evans, W. F., 1914. 'The old north wall at Cowbridge, South Wales'. *Archaeologia Cambrensis* **XIV, Part II**, 304.

James, B. LL and Francis, D.J., 1979: *Cowbridge and Llanblethian past and present*, Barry, 199 pp.

Kelly's South Wales Directory 1891.

Leijerstam, A.,1992. *Aspect of Cowbridge*, Bridgend, 80 pp.

Marches Archaeology, 1999, *The Town Walls. A report on a desk based assessment*. Report deposited with HER.

Morgannwg 1983. 'Archaeological notes'. *Morgannwg* **27 (1983)**, 70-71

Parkhouse, J. and Evans, E. (eds), 1996. *Excavations in Cowbridge, South Glamorgan, 1977-88*, BAR 245, Oxford, 252 pp.

RCAHMW, 1982, *An Inventory of the Ancient Monuments in Glamorgan Vol III pt2: Secular Non-defensive Monuments* HMSO, Cardiff

RCAHMW, 1988, *An Inventory of the Ancient Monuments in Glamorgan Vol III pt2: Secular Non-defensive Monuments* HMSO, Cardiff

Robinson, D. M. 1980. *Cowbridge*, Glamorgan Gwent Archaeological Trust, 85 pp.

Soulsby I., 1983. *The towns of Medieval Wales*, Phillimore and Co

Spence, C.(ed.), 1990. *Archaeological Site Manual*. Department of Urban Archaeology, Museum of London.

Spurgeon, C. J., 2001. 'The medieval town defences of Glamorgan'. *Studia Celtica*, **XXXV(2001)**, 161-212.

Youngs, S. M. and Clark, J. 1982. 'Medieval Britain in 1981'. *Medieval Archaeology* **26**, 224 No 217,

#### **Cartographic sources:**

Plan of the town and township of Cowbridge in the County of Glamorgan, 1841 (Glamorgan Record Office, Cardiff)

OS map, Glamorganshire XLV-3, 1st edition 1877, 1/2500 (Cathays Heritage Library, Cardiff)

OS map, Glamorganshire XLV-3, 2nd edition 1899, 1/2500 (Cathays Heritage Library, Cardiff)

OS map, Glamorganshire XLV-3, 3rd edition 1919, 1/2500 (Cathays Heritage Library, Cardiff)

## **11 Appendices**

### 11.1 Summary list of contexts

| <b>No.</b> | <b>Location</b> | <b>Brief description</b>        | <b>Relationship</b> | <b>Notes</b> |
|------------|-----------------|---------------------------------|---------------------|--------------|
| 01         |                 | Concrete paving tile            | Over 02             | 20th C       |
| 02         |                 | Cement bedding layer            | Over 03, 10         | 20th C       |
| 03         |                 | Concrete slab                   | 04                  | 20th C       |
| 04         |                 | Concrete slab                   | 04                  | 20th C       |
| 05         |                 | Cut for retail unit foundations | Under 02, 04        | 20th C       |
| 06         |                 | Retail unit concrete footings   | In 05               | 20th C       |
| 07         |                 | Aggregates, fill of 05          | In 05               | 20th C       |
| 08         |                 | Made ground                     | Under 04            | 20th C       |
| 09         |                 | Buried top soil                 | Under 04, 08, 13    | 19th C ?     |
| 10         |                 | Brown-orange clay               | Under 09            | 19th C ?     |
| 11         |                 | Made ground                     | Under 02            | 20th C       |
| 12         |                 | Made ground                     | Under 02            | 20th C       |
| 13         |                 | Lime mortar floor bedding layer | Under 12            | 19th C ?     |
| 14         |                 | Rectangular stone building      | In 09               | 19th C ?     |

Cowbridge 2018  
7 Penny Lane

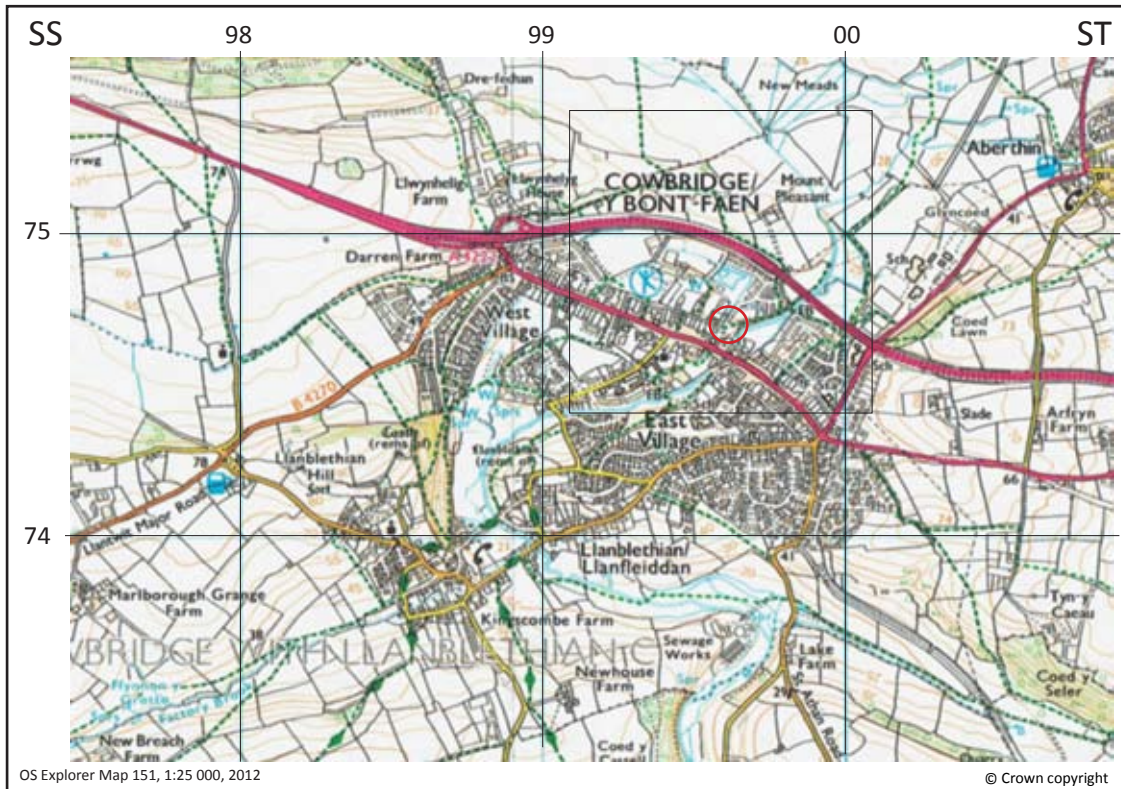

○ 7 Penny Lane, Cowbridge

Figure 1: Location maps

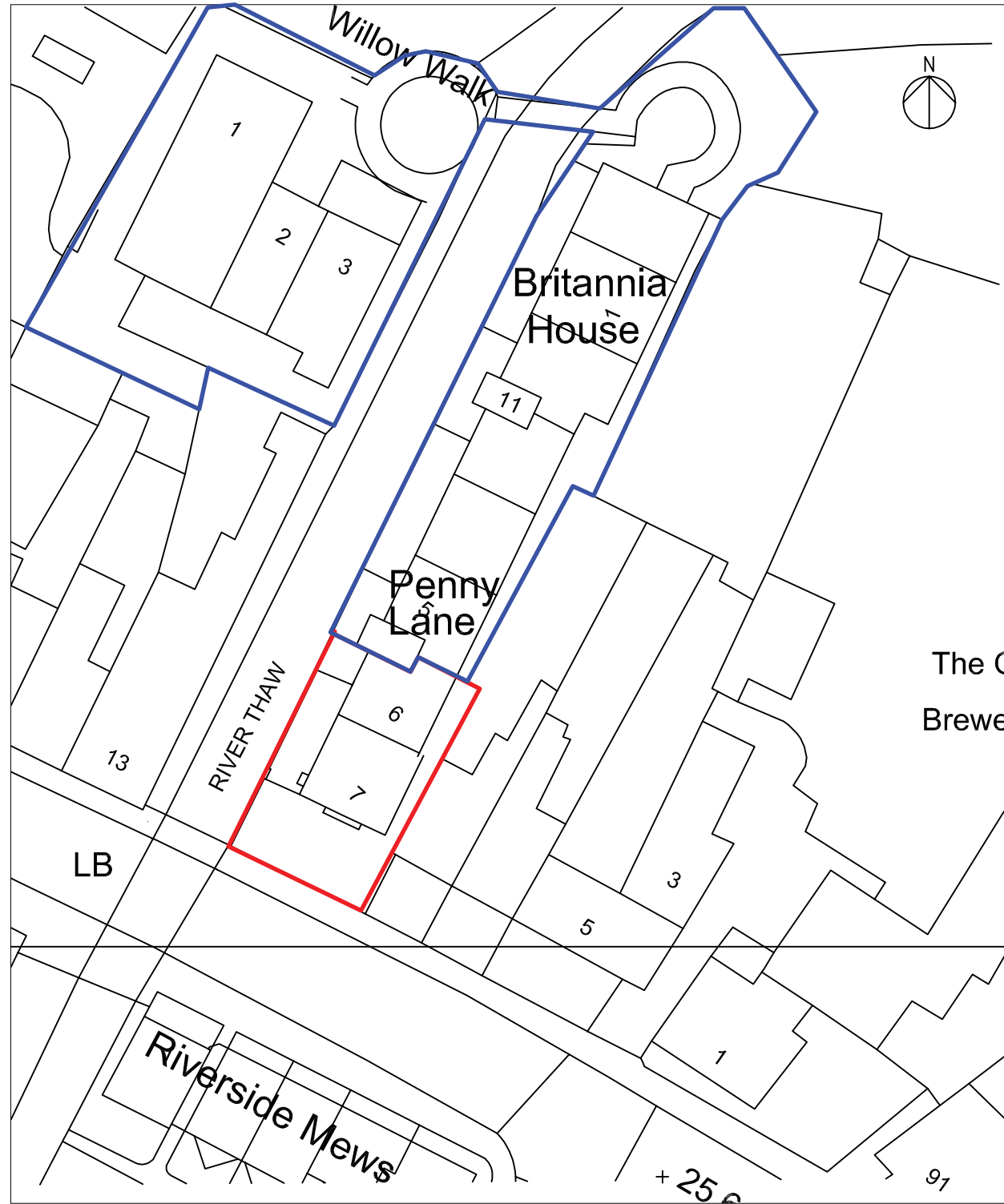

SITE PLAN 1:500

 Proposed development area

Figure 2: Location plan

Project Name and Address  
 EXTENSION  
 BRITANNIA HOUSE  
 OLD MASONS YARD  
 COWBRIDGE  
 VALE OF GLAMORGAN  
 CF71 7EG

|                                            |                   |
|--------------------------------------------|-------------------|
| Client<br>S.Andrews & Son<br>(Pwellhi) Ltd | Sheet<br>(SV)1001 |
| Date<br>May 2016                           | SITE<br>PLANS     |
| Scale<br>1:500 @ A3                        |                   |

Architect:  
 NICK RENWICK CHARTED ARCHITECT  
 6 Old Hall, Cowbridge  
 Vale of Glamorgan. CF71 7AH

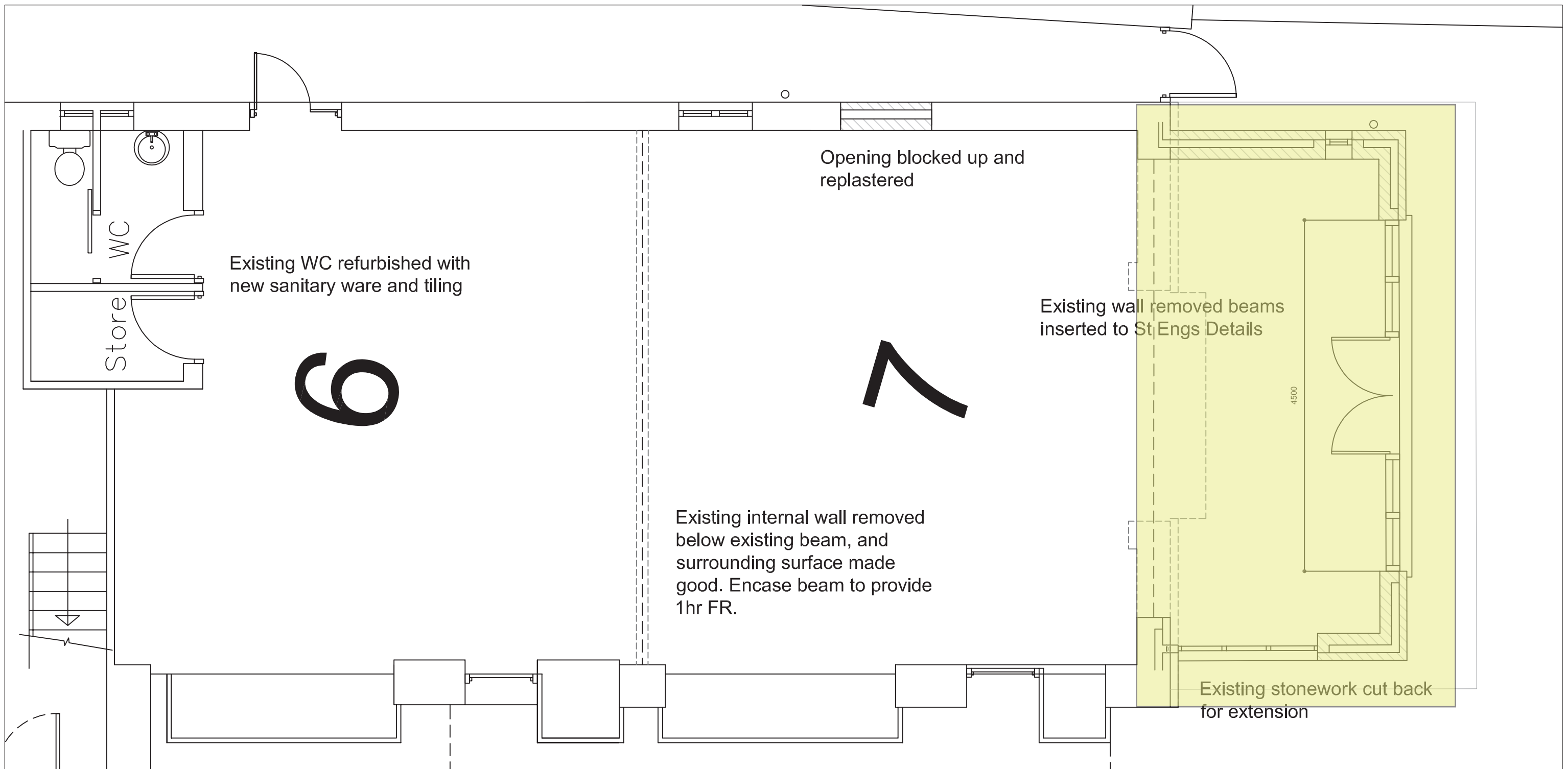

GROUND FLOOR PLAN

 Watching brief area

All existing windows & doors refurbished or replaced with new, doors fixed shut

Figure 3: Existing site plan and location of the watching brief area

Project Name and Address  
 EXTENSION  
 BRITANNIA HOUSE  
 OLD MASONS YARD  
 COWBRIDGE  
 VALE OF GLAMORGAN  
 CF71 7EG

|                                            |                   |
|--------------------------------------------|-------------------|
| Client<br>S.Andrews & Son<br>(Pwellhi) Ltd | Sheet<br>(99)1010 |
| Date<br>DEC 2016                           | DETAIL<br>PLAN    |
| Scale<br>1:50 @ A3                         |                   |

NICK RENWICK CHARTERED ARCHITECT  
 6 Old Hall, Cowbridge  
 Vale of Glamorgan. CF71 7AH

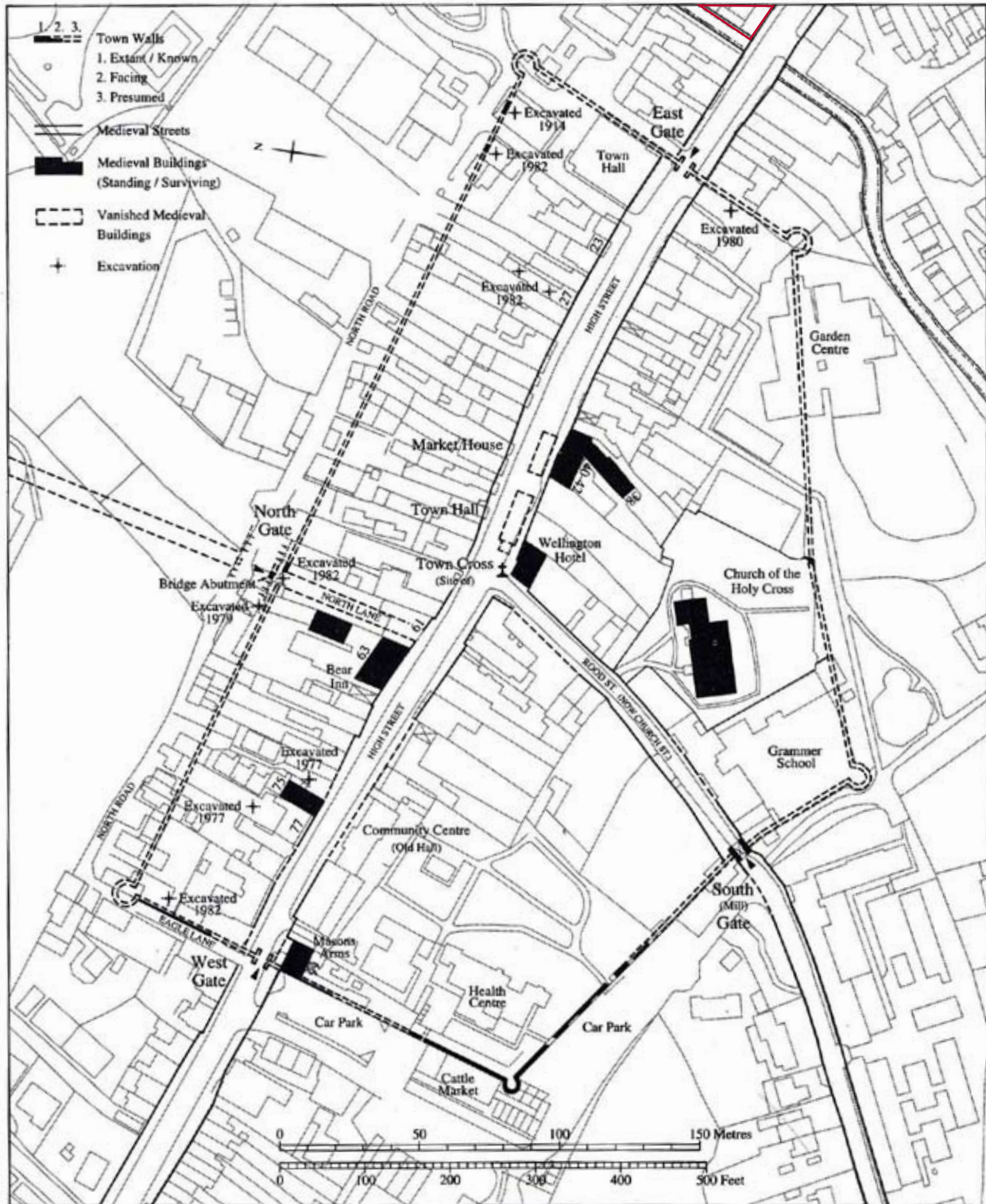

— Proposed development

Figure 4: Cowbridge, plan of the town defences (Spurgeon 2001, 180)

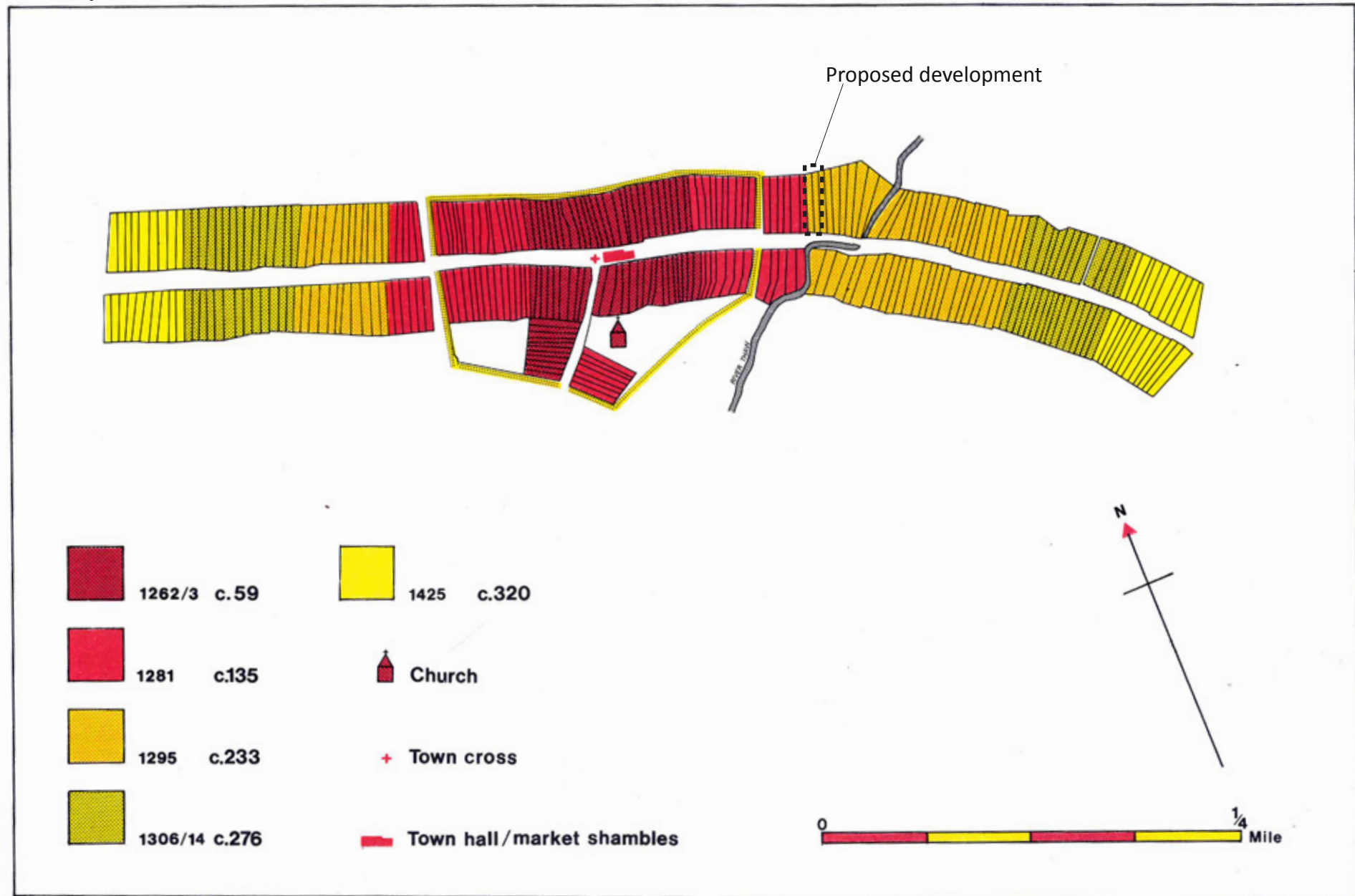
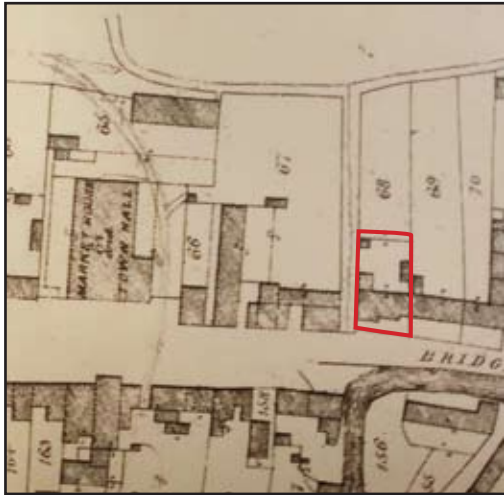

Figure 5: The medieval burgage plots (Robinson 1980, Fig. 10)

Cowbridge 2018  
7 Penny Lane



A: 1841



B: 1877

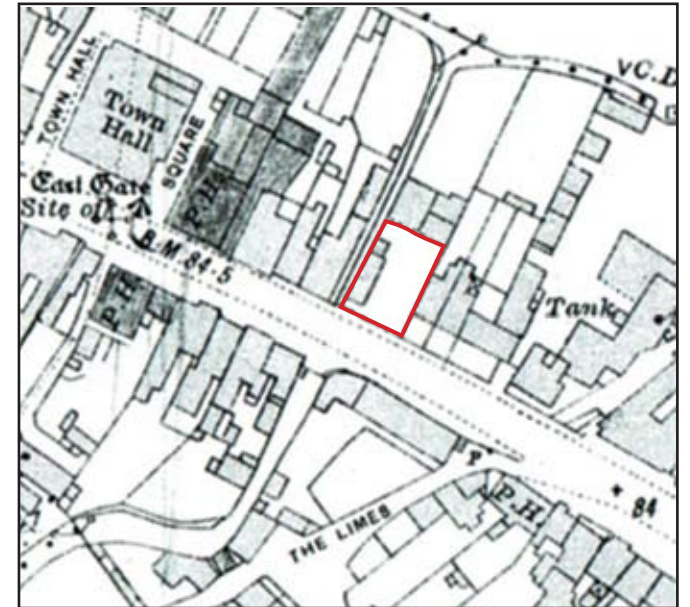

C: 1919

 Proposed development area

Figure 6: The proposed development area between 1841 and 1919

Retail unit

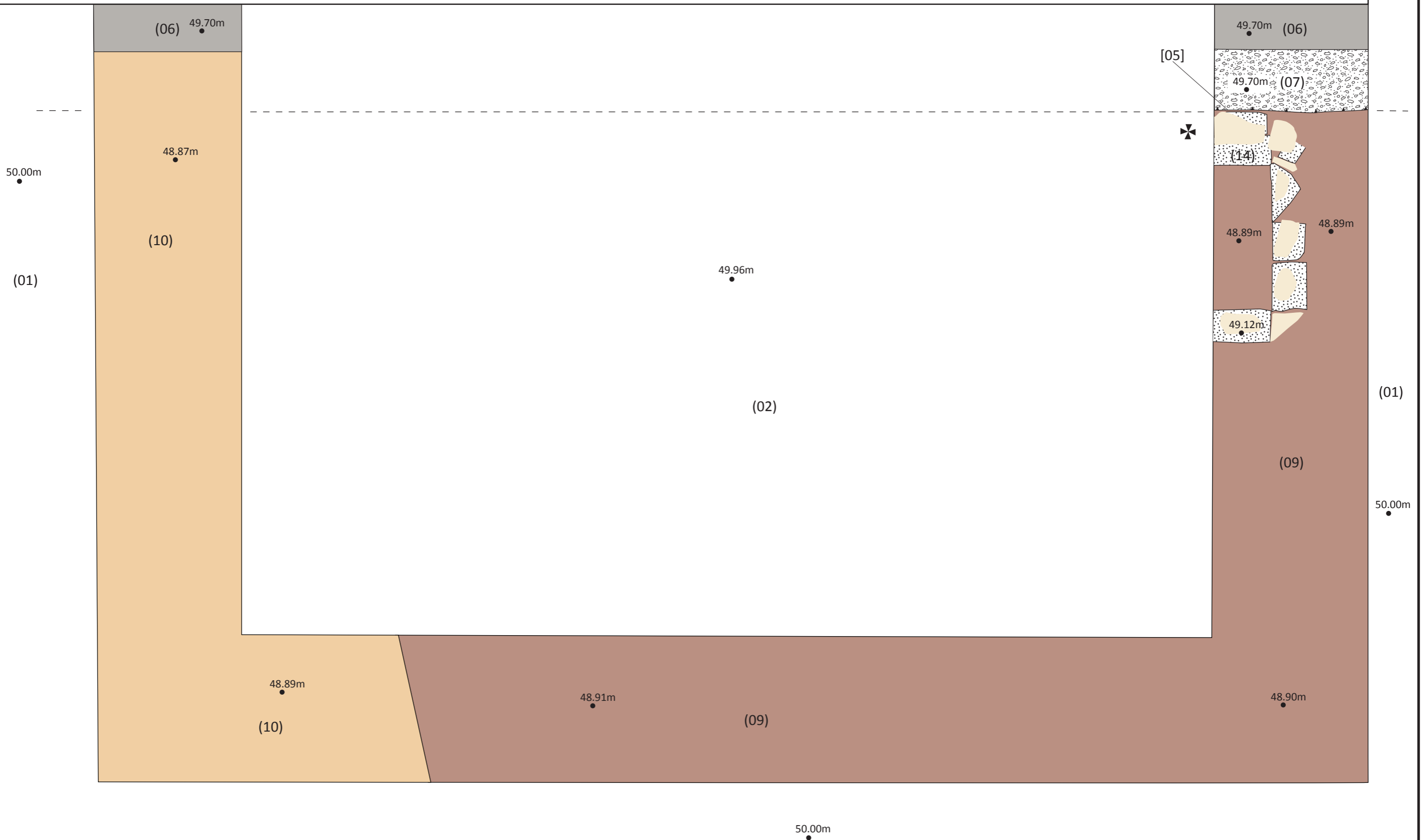
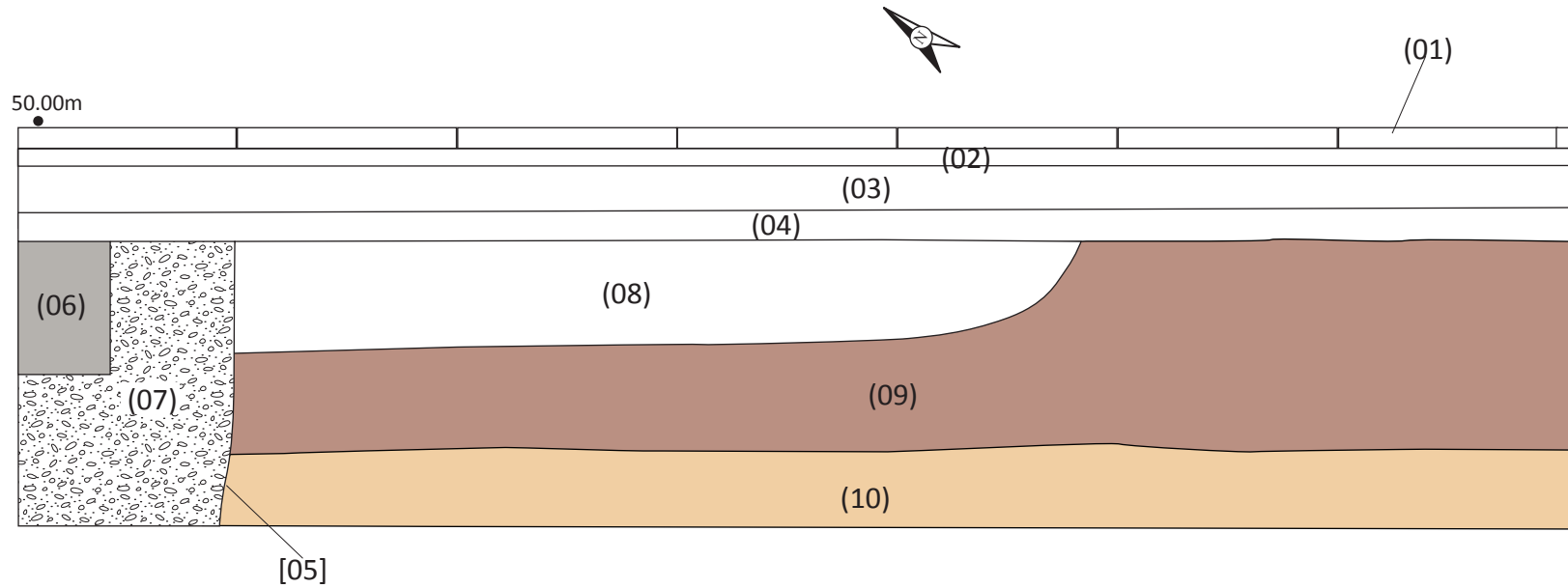
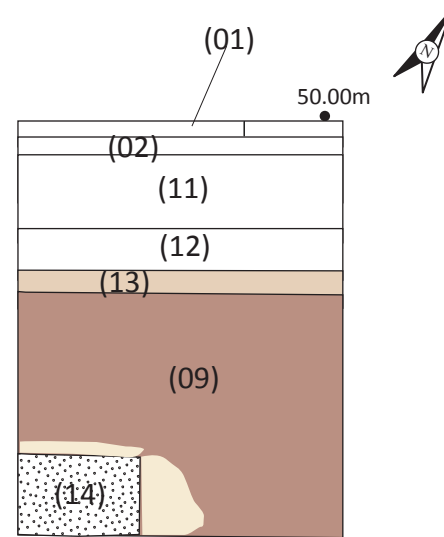

Figure 7: Plan of the excavated area



Section 01



Section 02



-  Concrete
-  Cement render

Figure 8: Sections



Plate 1: The watching brief area from the south-west



Plate 2: Typical section from the south



Plate 3: The building 14 from the south



Plate 4: The building 14 from the west